

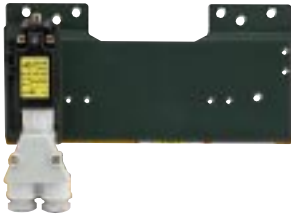

LIGHTING DEVICES WITH POSITIONING LIMIT SWITCH, DIN PITCH

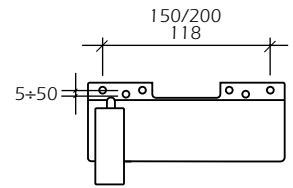

gr.		CODE
560	BASIC BRACKET + ADJUSTMENT 2NC	050DIF02
	1NC+NO	050DIF11



LIGHTING DEVICES WITH INTERLOCK LIMIT SWITCH, DIN PITCH



gr.		CODE
550	BASIC BRACKET + ADJUSTMENT 3NC	050DIF103
	1NA + 2NC	050DIF112

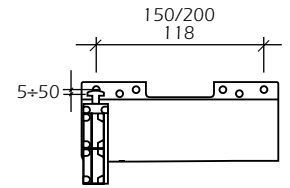

MODULAR CEILING LIGHTS ADAPTABLE TO DIN PITCH LIGHTING DEVICES AND APPLIANCES



gr.		CODE
1365	8W 220V 50Hz	050SPL8

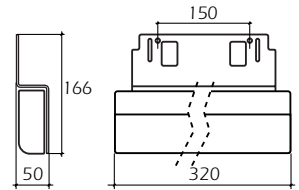

gr.		CODE
1816	15W 220V 50Hz 15W 120V 60Hz	050SPL15 050SPL15-60

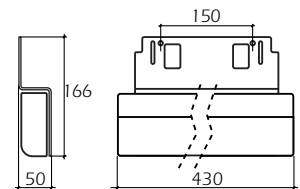

gr.		CODE
2160	18W 220V 50Hz	050SPL18

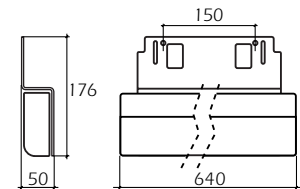

gr.		CODE
1092	E27 220V 60W max	050SPL100

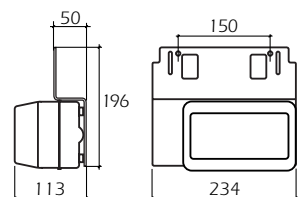



MODULAR LIGHTING SYSTEM

COMPLETE SIGNALLING DEVICES

VERSIONS WITH FASTENING BRACKETS FOR DIN 25 PITCH ELECTRICAL CABINET INSTALLATION

SIGNALLING UNITS

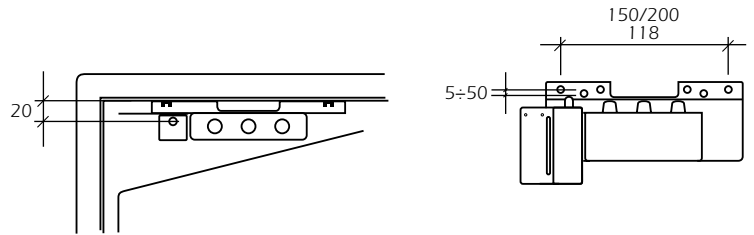
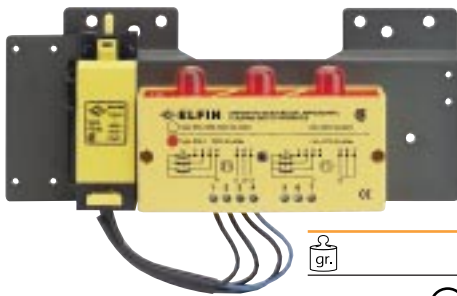

gr.	POWER SUPPLY VOLTAGE	CONFIGURATION	CODE
700	3~ 220 V. 50÷60 Hz	with limit switch ⁽¹⁾	050ASL220
	1~ 110÷127 V. 50÷60 Hz		
	3~ 380÷600 V. 50÷60 Hz	with limit switch ⁽¹⁾	050ASL500
	1~ 220÷350 V. 50÷60 Hz		

SIGNALLING AND PROTECTION UNITS WITH ELECTRICAL INTERLOCK FOR AUXILIARY AND SERVICE CIRCUITS⁽⁴⁾

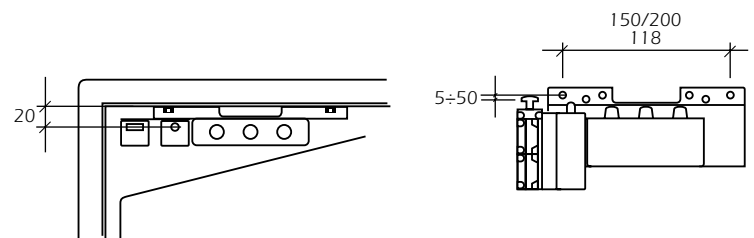
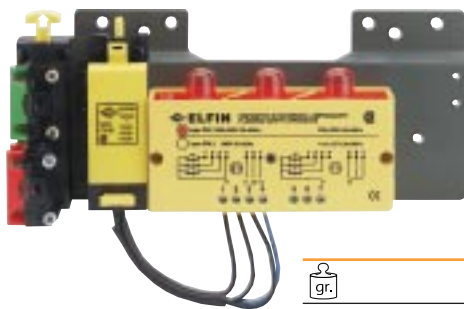

gr.	POWER SUPPLY VOLTAGE	CONFIGURATION	CODE
760	3~ 220 V. 50÷60 Hz	interlock 1NC ⁽²⁾	050ASL220FI01
		interlock 1NO ⁽³⁾	050ASL220FI10
800	1~ 110÷127 V. 50÷60 Hz	interlock 1NC ⁽²⁾ +2NC ⁽⁴⁾	050ASL220FI03
		interlock 1NO ⁽³⁾ +2NC ⁽⁴⁾	050ASL220FI12
760	3~ 380÷600 V. 50÷60 Hz	interlock 1NC ⁽²⁾	050ASL500FI01
		interlock 1NO ⁽³⁾	050ASL500FI10
800	1~ 220÷350 V. 50÷60 Hz	interlock 1NC ⁽²⁾ +2NC ⁽⁴⁾	050ASL500FI03
		interlock 1NO ⁽³⁾ +2NC ⁽⁴⁾	050ASL500FI12

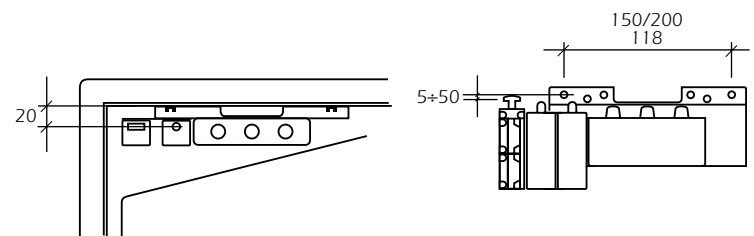
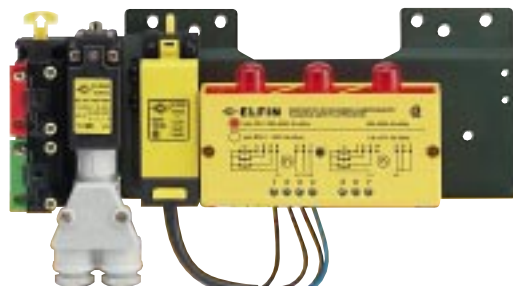

gr.	POWER SUPPLY VOLTAGE	CONFIGURATION	CODE
958	3~ 380÷600 V. 50÷60 Hz	interlock 1NC ⁽²⁾ +1NO ⁽³⁾	050ASL5FI11F02
		limit switch 2NC	



(1) Three-pole limit switch wired to the flashing device. Switches this on only when the doors of the cabinet are opened.

(2) With current inrush

(3) With minimum voltage

(4) Normally used to switch on lighting and to switch off fans or conditioners



MODULAR LIGHTING SYSTEM

COMPLETE SIGNALLING DEVICES

VERSIONS WITH ASSEMBLY BRACKETS FOR INSTALLATION INSIDE CABINETS

SIGNALLING UNITS

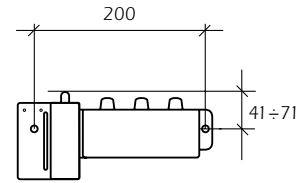
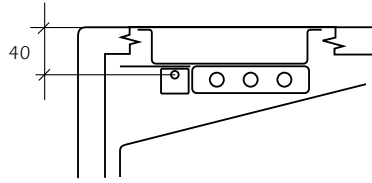

gr.	POWER SUPPLY VOLTAGE	CONFIGURATION	CODE
470	3~ 220 V. 50÷60 Hz	with limit switch ⁽¹⁾	050ASL2
	1~ 110÷127 V. 50÷60 Hz		
	3~ 380÷600 V. 50÷60 Hz	with limit switch ⁽¹⁾	050ASL3
	1~ 220÷350 V. 50÷60 Hz		

SIGNALLING AND PROTECTION UNITS WITH ELECTRICAL INTERLOCK FOR AUXILIARY CIRCUITS

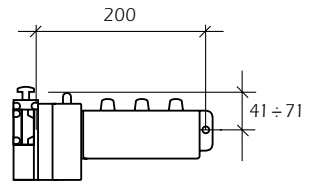
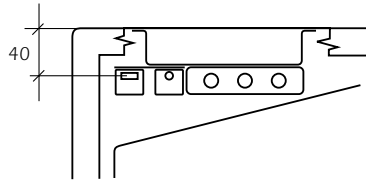
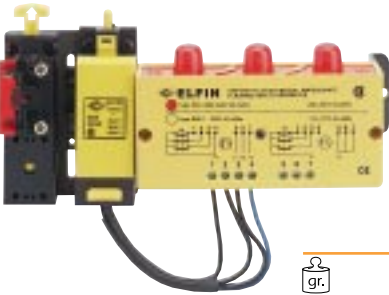

gr.	POWER SUPPLY VOLTAGE	CONFIGURATION	CODE
530	3~ 220 V. 50÷60 Hz	interlock1NC ⁽²⁾	050ASL2FI01
	1~ 110÷127 V. 50÷60 Hz	interlock1NO ⁽³⁾	050ASL2FI10
	3~ 380÷600 V. 50÷60 Hz	interlock1NC ⁽²⁾	050ASL3FI01
	1~ 220÷350 V. 50÷60 Hz	interlock1NO ⁽³⁾	050ASL3FI10



gr.	CODE
167	050ASPLD11

FLASHING ILLUMINATED PUSH-BUTTON
DIRECT POWER SUPPLY 24V 1 NO + 1 NC



(1) Three-pole unit switch wired to the flashing device. Switch this on only when the doors of the cabinet are opened.

(2) With current in rush.

(3) With minimum voltage.

(4) Normally used to switch on lighting and to switch off fans or conditioner.



FASTENING BRACKETS

FASTENING BRACKETS AND PLATES



	BASIC BRACKET	CODE
365	DIN 25 PITCH	050S006

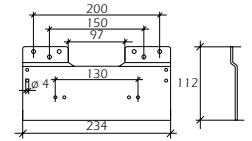

	SLIDING BRACKET FOR CEILING LIGHT	CODE
670	FLUORESCENT	050S016

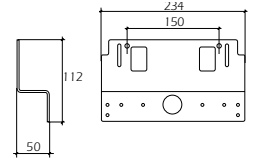

670	INCANDESCENT	050S017
-----	--------------	----------------

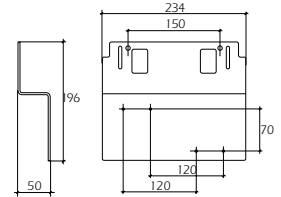

	BASIC BRACKET	CODE
150	FOR FASTENING INSIDE CABINETS	050S001

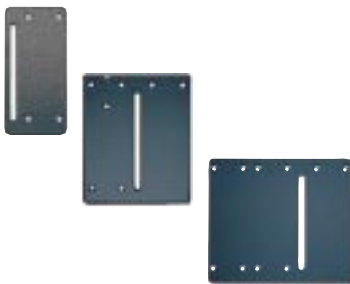
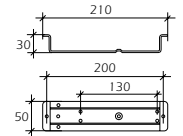

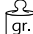
	SLIDING BRACKET	CODE
63	1 FASTENER	050S002
127	2 FASTENERS	050S011
162	3 FASTENERS	050S010

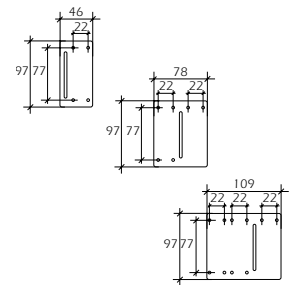

	OMEGA RAIL BRACKET	CODE
128	DIN 35mm	050S013

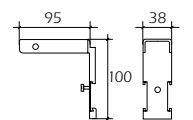

	BRACKET FOR OPERATORS	CODE
104		050S015

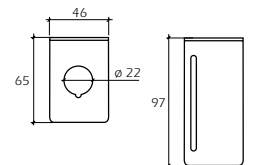

	MAGNETIC PLATE	CODE
314	FOR FLUORESCENT CEILING LIGHT ⁽¹⁾	050S019

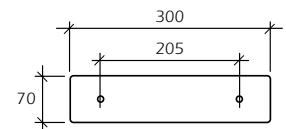

	MAGNETIC PLATE	CODE
235	FOR INCANDESCENT CEILING LIGHT	050S020

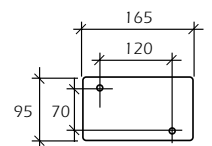

Use of this component together with the components and accessories listed above makes it possible to configure the appliance according to specific requirements.
 (1) Adaptable ceiling lights 050PL8 - 050PL15 - 050PL15-60 - 050LQP - 050LQS



FLASHING DEVICES

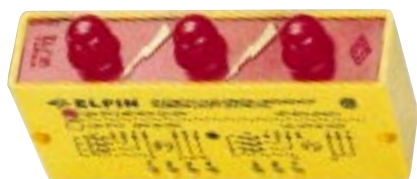

POWER SUPPLY VOLTAGE		CODE
3~	220 V. 50÷60 Hz	050DSL2
1~	110÷127 V. 50÷60 Hz	
3~	380÷600 V. 50÷60 Hz	050DSL3
1~	220÷350 V. 50÷60 Hz	
3~	600÷660 V. 50÷60 Hz	050DSL6
1~	440÷500 V. 50÷60 Hz	

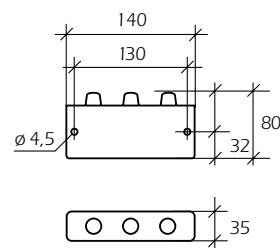

gr. 130

TECHNICAL DATA

POSSIBLE CONNECTIONS

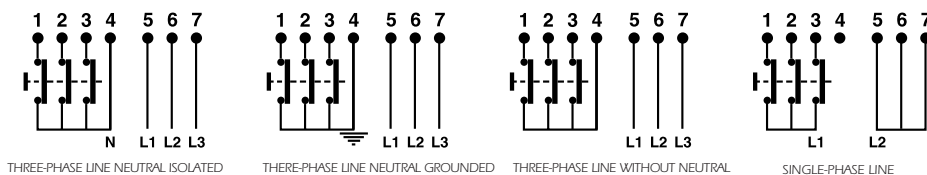

CONFORMING TO STANDARDS

IEC 947-5-1. CEI 7.45 VDE - UTE - BSI CENELEC, EN 60947.5.1

APPROVALS

CSA (CANADA)

PROTECTIVE TREATMENT⁽¹⁾

Standard version : "TC"

AMBIENT TEMPERATURE⁽¹⁾

Operation $\geq -25C^{\circ} \div \leq +65C^{\circ}$. Storage $\geq -35C^{\circ} \div \leq +70C^{\circ}$.

TERMINAL DEGREE OF PROTECTION

IP2X conforming to IEC 529

ELECTRIC SHOCK PROTECTION⁽¹⁾

Class II double insulation conforming to IEC 536

TERMINAL TORQUE

max. 0.5 Nm, M3 screw, slot type

TERMINAL CLOSING CAPACITY

max. 1 x 12 AWG conductor (3.3 mm²)

RATED INSULATION VOLTAGE

Ui 690 A.C.

COMPLIANCE WITH EMC DIRECTIVES

EN 50081-2 EN 50082-2 EN 55022, CEI EN 61000-4-2. Conducted emission. Radiated emission. Immunity to ESD. Immunity to BURSTS.

LEVEL OF POLLUTION ⁽¹⁾

Class 3 conforming to DIN VDE 0110



(1) Values referring to all components and accessories



ELECTRICAL INTERLOCK LIMIT SWITCHES FOR AUXILIARY AND SERVICE CIRCUITS



This device is activated directly by each door of the cabinet. The auxiliary circuits of the switchgear are usually connected on the first contact element (the only one on which the interlock device can act). The remaining contacts mounted to the rear are used for the service circuits such as, for example: switching on of the cabinet light, activation of fans, conditioner, audible signals, beacons. With the doors open, it can be activated manually using a handy button marked by an arrow, performing various functions⁽³⁾.

Diagram	Diagram	Diagram	CODE
			050FI01⁽¹⁾
			050FI10⁽²⁾
			050FI03⁽¹⁾
			050FI12⁽²⁾
			050FI01⁽¹⁾+FCP+FAP
			050FI10⁽²⁾+FCP+FAP

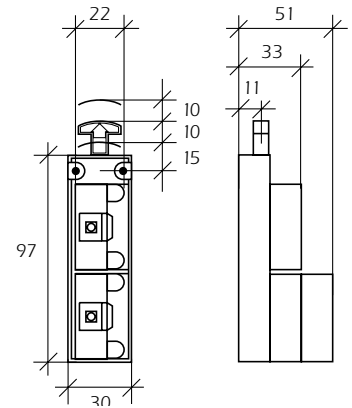

Normal conditions are reset each time the door of the cabinet is closed.

CONTACT ELEMENTS FOR INTERLOCK LIMIT SWITCH(4)

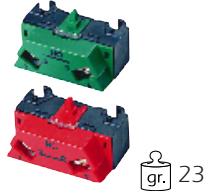

CONTACT	DIAGRAM	COLOUR OF PROTECTION	CODE
1NA			030FA-P
1NC			030FC-P

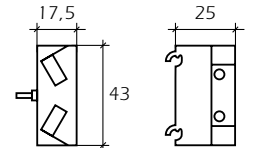

TECHNICAL DATA

CONFORMING TO STANDARDS	IEC 947-5-1 VDE 0660 - UTE - BSI CENELEC																
APPROVALS	CSA (CANADA)																
TERMINAL DEGREE OF PROTECTION	IP 2X conforming to IEC 529																
TERMINAL TORQUE	↻ 1.5 Nm, M4 screw, self-lifting captive cable clamp $\geq 3\text{mm}^2$, $\leq 2 \times 2,5\text{mm}^2$																
RATED INSULATION VOLTAGE U_i	750 V conforming to IEC 947-5-1																
RATED THERMAL CURRENT I_{th}	10A																
RATED OPERATIONAL POWER	conforming to IEC 947-5-1 catAC15																
	<table border="1"> <thead> <tr> <th>Voltage U_e</th> <th>V</th> <th>60</th> <th>110</th> <th>220</th> <th>380</th> <th>500</th> <th>600</th> </tr> </thead> <tbody> <tr> <td>Current I_e</td> <td>A</td> <td>10</td> <td>6</td> <td>3</td> <td>2</td> <td>1,5</td> <td>1,2</td> </tr> </tbody> </table>	Voltage U_e	V	60	110	220	380	500	600	Current I_e	A	10	6	3	2	1,5	1,2
Voltage U_e	V	60	110	220	380	500	600										
Current I_e	A	10	6	3	2	1,5	1,2										

SCREWS FOR CONTACT ELEMENT ASSEMBLY



Quantity	Description	CODE
2	ASSEMBLY 1 ELEMENT	030004
3	ASSEMBLY 2 ELEMENTS OVERLAPPED	030006
4	ASSEMBLY 3 ELEMENTS OVERLAPPED	030005

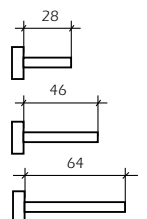

(1) Current inrush

(2) With minimum voltage

(3) For different combinations, purchase separate contact elements

(4) For contact performance and characteristics, see the related chapter in the push-button catalogue "Series EL SG \varnothing 30" c/w lock screws



FC TYPE THREE-POLE LIMIT SWITCH



VERSION		CODE
3NC		050FC3C
2NC+1NO		050FC2C
1NC+2NO		050FC1C
3NO		050FC0C

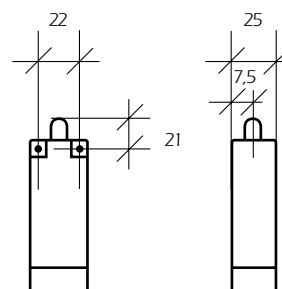

gr. 62

TECHNICAL DATA

CONFORMING TO STANDARDS

IEC 947-5-1. CEI

APPROVALS

CSA (CANADA)

DEGREE OF PROTECTION

IP40 conforming to IEC 529

TERMINAL TORQUE

max. 0.5 Nm, M3.5 screw, self-lifting captive cable clamp, combined head DIN 7962 31x0,05mm², ±2x2,5mm²

RATED INSULATION VOLTAGE

Ui 660 V

RATED THERMAL CURRENT I_{th}

10A

RATED OPERATIONAL POWER

Conforming to IEC 947-5-1
catAC15

Voltage U _e	V	110	220	380	500	600
Current I _e	A	6	3	2	1,5	1,2

CONTACT OPERATION

Slow break, self-cleaning sliding activation, NC, positive action

POSITIONING LIMIT SWITCH



gr. 60

Insulation voltage U_i = 500 V AC or 600 V DC - Nominal thermal current I_{th} = 10A

CATEGORIES OF USE

Alternating current	220	380	500
Voltage of use U _e (V)	6	4	1
Current of use I _e (A)			



gr. 45



gr. 13

ITEM	CODE
LIMIT SWITCH 1 NC + 1 NO	050F11
LIMIT SWITCH 2NC	050F02
LIMIT SWITCH 2NO	050F20
2-WAY PG13.5 CABLE CLAMP	010N2PG13,5
PG13.5 CABLE CLAMP	010NPG13,5

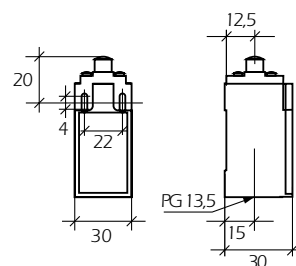



MODULAR LIGHTING SYSTEM

COMPONENTS AND ACCESSORIES

ILLUMINATED UNITS(1)



gr.	CODE
21	020LOBIRS72

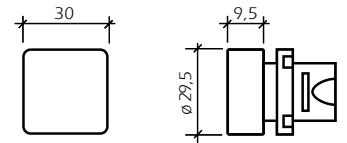

ILLUMINATED PUSH-BUTTONS⁽¹⁾



gr.	CODE
25 NORMAL	020PQAFLRKS72
JOG TYPE	020PPQAFLRKS72

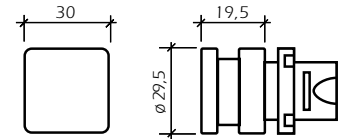

IP40 FLUORESCENT CEILING LIGHTS



gr.	POWER SUPPLY VOLTAGE	CODE
719	ALIM. 220 50 Hz 15W	050PL8

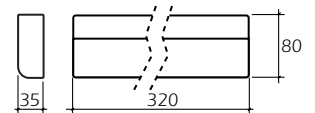

Body made of powder-enamelled aluminium.
Metacrylate diffusor



gr.	POWER SUPPLY VOLTAGE	CODE
1.280	220V 50 Hz 15W	050PL15
1.280	120V 60 Hz 15W	050PL15-60

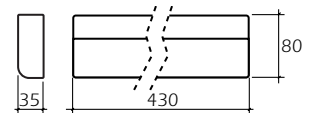

Body made of powder-enamelled aluminium.
Metacrylate diffusor



gr.	POWER SUPPLY VOLTAGE	CODE
1572	220 50 Hz 18W	050PL18

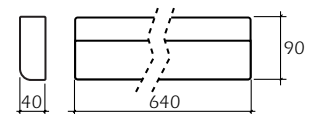

Body made of powder-enamelled steel.
Metacrylate diffusor
Mirror type parabola

CEILING LIGHTS FOR INCANDESCENT BULB



gr.	POWER SUPPLY VOLTAGE	CODE
309	250 V 100 W max	050PL100

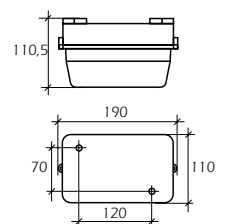

Lamp-holder E 27 Class IP 44.
Resistant to flame and ignition conforming to IEC 695-2-1 and CEI 50-11
Polycarbonate diffusor.



(1) For other versions of operators and lamp-holders, refer to the SM2 020 series manual pilot devices \varnothing 22 catalogue.