

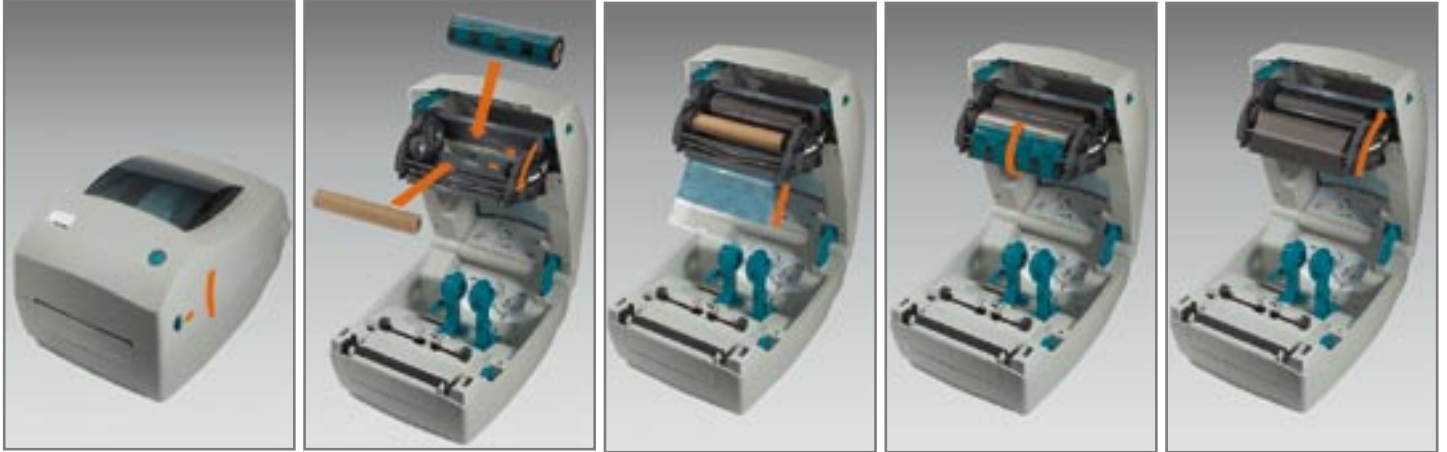

INSERTION OF INK TAPE



Pull the buttons at the sides and lift the cover

Tip the tape holder. Insert the tape and the receiving spool (1) as shown, pressing the spring terminals

Unwind the tape from the back

Stick the adhesive part to the receiving spool and tighten the tape by adjusting the toothed wheel at the side

Tip the tape holder

INSERTION OF LABEL TAPE

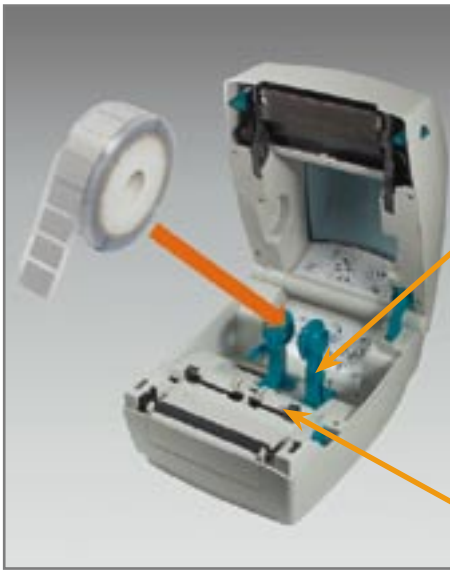

Open the holder, sliding it and releasing it after positioning the tape. Regulate the opening of the tape guide by adjusting the wheel at the side. Insert the label tape into the holder.



Slide the tape and press the cover of the holder to close it



In addition to the power switch and socket, the rear panel features three connection ports: serial, parallel and USB



When the transfer tape is finished, use the empty spool as the receiver for the next tape.