

Installation includes three phases:

- 1<sup>st</sup> safe, secure fastening of the complete appliance to the structure of the cabinet using different templates;
- 2<sup>nd</sup> minor adjustments of each individual control component toward the leaf of the door using a sliding bracket
- 3<sup>rd</sup> optimisation of the light source

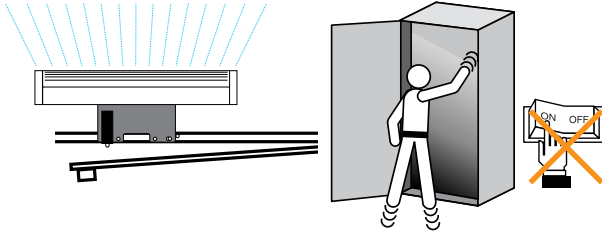

Automatic switching on of the light when the door is opened eliminates the need to search for switches in a dim, hazardous environment, also avoiding any dangerous "acrobatics" in the case of large cabinets.

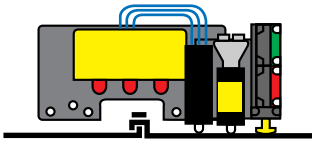

Presetting for double-door cabinets with central lock.



The particular shape of the bulbs assures protection against glare regardless of the position of the light inside the cabinet.

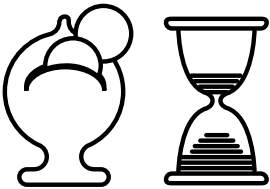

The system also promotes considerable energy saving and longer bulb life in that this remains on only for the time during which the cabinet is open.

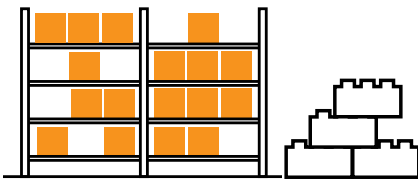

The extensive modularity of the system and the vast range of possible applications makes it possible to optimise management and the cost of stocks.

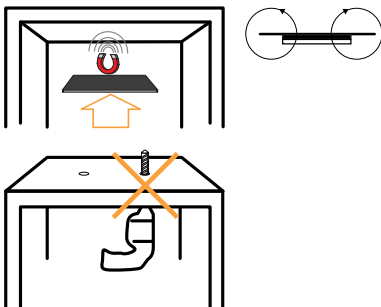

Where the lights cannot be installed using modular brackets, the magnetic plates ensure fast, trouble-free application without having to drill holes in the walls of the cabinets and permit adjustment of the light as required. Permanent magnets. Complete closing of the magnetic field.



